

Drain: SPRINGS AT CAMBRIDGE DRAIN **Drain #:** 262
Improvement/Arm: SPRINGS AT CAMBRIDGE - FOX HOLLOW AT WEST - SECTION 1
Operator: JDH **Date:** 7-2-04
Drain Classification: Urban/Rural **Year Installed:** 2003

GIS Drain Input Checklist

- Pull Source Documents for Scanning JDH
- Digitize & Attribute Tile Drains N/A
- Digitize & Attribute Storm Drains JDH
- Digitize & Attribute SSD JDH
- Digitize & Attribute Open Ditch N/A
- Stamp Plans JDH
- Sum drain lengths & Validate JDH
- Enter Improvements into Posse JDH
- Enter Drain Age into Posse JDH
- Sum drain length for Watershed in Posse JDH
- Check Database entries for errors JDH

Gasb 34 Footages for Historical Cost
Drain Length Log

Drain-Improvement: SPRINGS AT CAMBRIDGE DRAIN - FOX HOLLOW AT CRIST - SECTION D

| Drain Type: | Size: | Length <i>surveyed records</i> | Length (DB Query) | Length Reconcile | If Applicable: | |
|-------------|-------|---------------------------------------|----------------------|---------------------|----------------|-------|
| | | | | | Price: | Cost: |
| SSD | 6" | 5,508' | 5,508' | Ø | | |
| RQ | 12" | 754' | 754' | Ø | | |
| | 15" | 1,084' | 1,084' | Ø | | |
| | 18" | 418' | 418' | Ø | | |
| | | | | | | |
| | | | | | | |
| | | | | | | |
| | | | | | | |
| | | | | | | |
| | | | | | | |
| | | | | | | |
| | | | | | | |
| | | | | | | |
| | | | | | | |
| | | | | | | |

Sum: 7,764' 7,764' Ø _____

Final Report: _____

Comments:

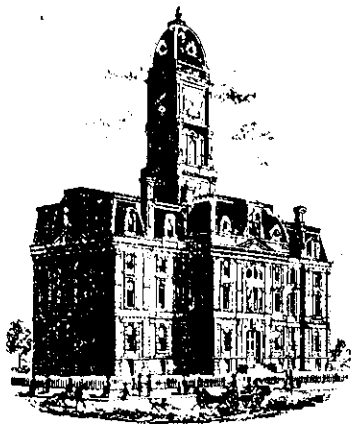

SURVEYOR'S OFFICE

Hamilton County

Kenton C. Ward, Surveyor

Phone (317) 776-8495

Fax (317) 776-9628

Suite 188

One Hamilton County Square

Noblesville, Indiana 46060-2230

October 17, 2003

TO: Hamilton County Drainage Board

RE: Springs of Cambridge Drain, Fox Hollow Section 1 Arm

Attached is a petition filed by Precedent Development along with a non-enforcement request, plans, calculations, quantity summary and assessment roll for the Fox Hollow Section 1 Arm, Springs of Cambridge Drain to be located in Fall Creek Township. I have reviewed the submittals and petition and have found each to be in proper form.

I have made a personal inspection of the land described in the petition. Upon doing so, I believe that the drain is practicable, will improve the public health, benefit a public highway, and be of public utility and that the costs, damages and expenses of the proposed drain will probably be less than the benefits accruing to the owners of land likely to be benefited. The drain will consist of the following:

| | | | |
|---------|-----------|---------|-----------|
| 6" SSD | 7,024 ft. | 15" RCP | 1,092 ft. |
| 12" RCP | 762 ft. | 18" RCP | 421 ft. |

The total length of the drain will be 9,299 feet.

The retention pond located in RCA # 1 is to be considered part of the regulated drain. Only the inlet and outlet will be maintained as part of the regulated drain. The maintenance of the pond, such as mowing, will be the responsibility of the Homeowners Association. The Board will however retain jurisdiction for ensuring the storage volume for which the lake was designed will be retained. Thereby, allowing no fill or easement encroachments.

The subsurface drains (SSD) to be part of the regulated drain are those located under the curbs and those main lines between lots or in rear yards. Only the main SSD lines which are located within the easement (right of way) are to be maintained as regulated drain. Laterals for individual lots will not be considered part of the regulated drain. The portion of the SSD which will be regulated other than those under curbs are as follows: Rear of lots 15, 16, 17, 1, 2, 3, 4, and 5.

I have reviewed the plans and believe the drain will benefit each lot equally. Therefore, I recommend each lot be assessed equally. I also believe that no damages will result to landowners by the construction of this drain. I recommend a maintenance assessment of \$ 5.00 per acre for common areas and platted lots, \$ 5.00 per acre for roadways, with a \$ 30.00 minimum. With this assessment the total annual assessment for this drain/this section will be \$ 1,307.70.

The petitioner has submitted surety for the proposed drain at this time. Surety shall be submitted prior to the approval of the Hamilton County Board of Commissioners/commencement of construction. The sureties which are in the form of a Performance Bond/Letter of Credit are as follows:

Agent: Bond Safeguard Insurance Co.
Date: June 3, 2003
Number: 5003804
For: Storm Sewers and Subsurface Drains
Amount: \$142,065.00

Agent: Bond Safeguard Insurance Co.
Date: June 3, 2003
Number: 5003806
For: Erosion Control
Amount: \$ 32,689.90

Parcels assessed for this drain may be assessed for the Bee Camp Drain at sometime in the future.

I believe this proposed drain meets the requirements for Urban Drain Classification as set out in IC 36-9-27-67 to 69. Therefore, this drain shall be designated as an Urban Drain.

I recommend that upon approval of the above proposed drain that the Board also approve the attached non-enforcement request. The request is for the reduction of the regulated drain easement to those easement widths as shown on the secondary plat for Fox Hollow at Geist, Section 1 as recorded in the office of the Hamilton County Recorder.

I recommend the Board set a hearing for this proposed drain for November 24, 2003.

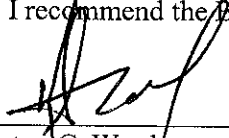

Kenton C. Ward
Hamilton County Surveyor

KCW/pll

BOND

HCDB 2003-00039

Bond No. 5003806

KNOW ALL MEN BY THESE PRESENTS, that we, Precedent Residential Development, LLC of 9339 Priority Way W. Drive, #100, Indianapolis, IN 46240 as Principal, and Bond Safeguard Insurance Company, a corporation organized under the laws of the State of Illinois, having its principal office in the City of Lombard, IL, as Surety, are held and firmly bound unto Board of Hamilton County Commissioners, Hamilton County, Indiana, in the sum of Thirty Two Thousand, Six Hundred Eighty Nine and 90/100 Dollars (\$32,689.90) lawful money of the United States, for which payment well and truly to be made, we bind ourselves, our heirs, executors, administrators, successors and assigns, jointly and severally, firmly by these presents.

WHEREAS, the above bounden Principal has been granted a permit for Fox Hollow at Geist, Section 1 - Erosion Control

NOW, THEREFORE, THE CONDITION OF THIS OBLIGATION IS SUCH, that is the above Principal shall indemnify and save harmless the Board of Hamilton County Commissioners, Hamilton County, Indiana against loss to which the Board of Hamilton County Commissioners, Hamilton County, Indiana may be subject by reason of said Principal's breach of any ordinance, rule or regulation relating to the above described license or permit, then this obligation shall be null and void, otherwise to remain in full force and effect.

The term of this bond is for a period beginning on the 29th day of May, 20 03 and ending on the 29th day of May 20 04.

No cause of action shall lie against the surety unless commenced within two years from the date the cause of action accrues against the principal.

RELEASE OF MAINTENANCE/PERFORMANCE BOND
RELEASE OF LETTER OF CREDIT
HAMILTON COUNTY BOARD OF COMMISSIONERS

BY: [Signature]
BY: [Signature]
BY: [Signature]

Signed, sealed and dated this 3rd day of June 20 03.

BOARD OF COMMISSIONERS
OF THE COUNTY OF HAMILTON

[Signature]
[Signature]

DATE 7-14-03

Precedent Residential Development, LLC

[Signature]

Bond Safeguard Insurance Company

[Signature]
Liana M. Shelton, Attorney-In-Fact

ATTEST: Babin M Mills
HAMILTON COUNTY AUDITOR

ATTEST: Babin M Mills
HAMILTON COUNTY AUDITOR

BOND

HCDB-2003-00040

Bond No. 5003804

KNOW ALL MEN BY THESE PRESENTS, that we, Precedent Residential Development, LLC of 9339 Priority Way W. Drive, #100, Indianapolis, IN 46240 as Principal, and Bond Safeguard Insurance Company, a corporation organized under the laws of the State of Illinois, having its principal office in the City of Lombard, IL, as Surety, are held and firmly bound unto Board of Hamilton County Commissioners, Hamilton County, Indiana, in the sum of One Hundred Forty Two Thousand, Sixty Five and 00/100 Dollars (\$142,065.00) lawful money of the United States, for which payment well and truly to be made, we bind ourselves, our heirs, executors, administrators, successors and assigns, jointly and severally, firmly by these presents.

WHEREAS, the above bounden Principal has been granted a permit for Fox Hollow at Geist, Section 1 - Storm Sewers and Subsurface Drains

NOW, THEREFORE, THE CONDITION OF THIS OBLIGATION IS SUCH, that is the above Principal shall indemnity and save harmless the Board of Hamilton County Commissioners, Hamilton County, Indiana against loss to which the Board of Hamilton County Commissioners, Hamilton County, Indiana may be subject by reason of said Principal's breach of any ordinance, rule or regulation relating to the above described license or permit, then this obligation shall be null and void, otherwise to remain in full force and effect.

The term of this bond is for a period beginning on the 29th day of May, 20 03 and ending on the 29th day of May 20 04.

No cause of action shall lie against the surety unless commenced within two years from the date the cause of action accrues against the principal.

Signed, sealed and dated this 3rd day of June 20 03.

Precedent Residential Development, LLC
[Signature]

Bond Safeguard Insurance Company
[Signature]
Lana M. Shelton, Attorney-In-Fact

Bond Safeguard INSURANCE COMPANY

KNOW ALL MEN BY THESE PRESENTS, that **BOND SAFEGUARD INSURANCE COMPANY**, an Illinois Corporation with its principal office in Lombard, Illinois, does hereby constitute and appoint:

Philip R. Peterson, Daniel T. Touw

Stuart Peterson, Donald C. Arbogast Jr., Liana M. Shelton, Norma J. Lerch

its true and lawful Attorney(s)-In-Fact to make, execute, seal and deliver for, and on its behalf as surety, any and all bonds, undertakings or other writings obligatory in nature of a bond.

This authority is made under and by the authority of a resolution which was passed by the Board of Directors of **BOND SAFEGUARD INSURANCE COMPANY** on the 7th day of November, 2001 as follows:

Resolved, that the President of the Company is hereby authorized to appoint and empower any representative of the Company or other person or persons as Attorney-In-Fact to execute on behalf of the Company any bonds, undertakings, policies, contracts of indemnity or other writings obligatory in nature of a bond not to exceed \$500,000.00, Five Hundred Thousand Dollars, which the Company might execute through its duly elected officers, and affix the seal of the Company thereto. Any said execution of such documents by an Attorney-In-Fact shall be as binding upon the Company as if they had been duly executed and acknowledged by the regularly elected officers of the Company. Any Attorney-In-Fact, so appointed, may be removed for good cause and the authority so granted may be revoked as specified in the Power of Attorney.

Resolved, that the signature of the President and the seal of the Company may be affixed by facsimile on any power of attorney granted, and the signature of the Vice President, and the seal of the Company may be affixed by facsimile to any certificate of any such power and any such power or certificate bearing such facsimile signature and seal shall be valid and binding on the Company. Any such power so executed and sealed and certificate so executed and sealed shall, with respect to any bond or undertaking to which it is attached, continue to be valid and binding on the Company.

IN WITNESS THEREOF, **BOND SAFEGUARD INSURANCE COMPANY** has caused this instrument to be signed by its President, and its Corporate Seal to be affixed this 7th day of November, 2001.



BOND SAFEGUARD INSURANCE COMPANY

BY 
David E. Campbell
President

ACKNOWLEDGEMENT

On this 7th day of November, 2001, before me, personally came David E. Campbell to me known, who being duly sworn, did depose and say that he is the President of **BOND SAFEGUARD INSURANCE COMPANY**, the corporation described in and which executed the above instrument; that he executed said instrument on behalf of the corporation by authority of his office under the By-laws of said corporation.



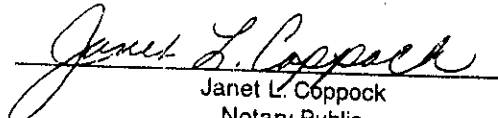

Janet L. Coppock
Notary Public

CERTIFICATE

I, the undersigned, Secretary of **BOND SAFEGUARD INSURANCE COMPANY**, An Illinois Insurance Company, DO HEREBY CERTIFY that the original Power of Attorney of which the foregoing is a true and correct copy, is in full force and effect and has not been revoked and the resolutions as set forth are now in force.

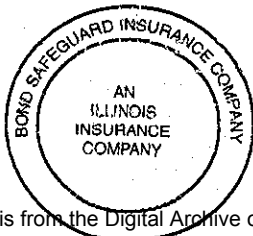
Signed and Sealed at Lombard, Illinois this 3rd Day of June, 20 03



Donald D. Buchanan
Secretary

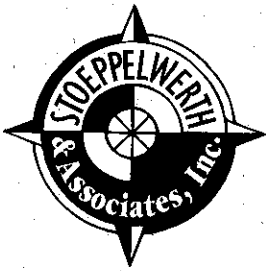

CONSULTING ENGINEERS
LAND SURVEYORS

R.M. Stoepelwerth, PE, PLS • David J. Stoepelwerth, PE, PLS • Curtis C. Huff, PLS • Dennis D. Olmstead, PLS • Jeffery W. Darling, PLS

CERTIFICATE OF COMPLETION AND COMPLIANCE

To: Hamilton County Surveyor

Re: Fox Hollow at Geist, Section One

I hereby certify that:

1. I am a Registered Land Surveyor or Engineer in the State of Indiana.
2. I am familiar with the plans and specifications for the above referenced subdivision.
3. I have personally observed and supervised the completion of the drainage facilities for the above referenced subdivision.
4. The drainage facilities within the above referenced subdivision to the best of my knowledge, information and belief have been installed and completed in conformity with all plans and specifications.

Signature: Jeffery W. Darling Date: December 1, 2003

Type or Print Name: Jeffery W. Darling

Business Address: Stoepelwerth & Associates, Inc.

9940 Allisonville Road, Fishers, Indiana 46038

Telephone Number: (317) 849-5935

SEAL INDIANA REGISTRATION NUMBER
900017



S/40605/Notice

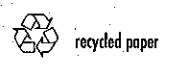

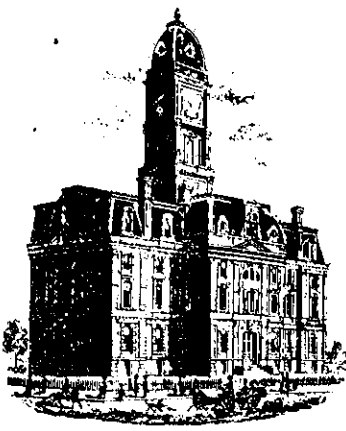

SURVEYOR'S OFFICE

Hamilton County

Kenton C. Ward, Surveyor
 Phone (317) 776-8495
 Fax (317) 776-9628

Suite 188
 One Hamilton County Square
 Noblesville, Indiana 46060-2230

To: Hamilton County Drainage Board

April 7, 2004

Re: Springs of Cambridge Drain: Fox Hollow at
 Geist Sec. 1 Arm

Attached are as-builts, certificate of completion & compliance, and other information for Fox Hollow at Geist Sec. 1. An inspection of the drainage facilities for this section has been made and the facilities were found to be complete and acceptable.

During construction, changes were made to the drain, which will alter the plans submitted with my report for this drain-dated October 17, 2003. The report was approved by the Board at the hearing held November 24, 2003. (See Drainage Board Minutes Book 7, Pages 256-258) The changes are as follows:

| Structure: | T.C.: | I.E.: | Pipe: | Length: | Grade: | Original: | Difference: |
|------------|--------|--------|-------|---------|--------|-----------|-------------|
| 108A | 832.4 | 823.58 | | | | | |
| 108 | 827.97 | 823.02 | 12 | 138 | 0.41 | 147 | -9 |
| 108 | 827.97 | 823.02 | | | | | |
| 107 | 827.73 | 822.7 | 12 | 28 | 1.14 | | |
| 107 | 827.73 | 822.7 | | | | | |
| 105 | 826.78 | 821.42 | 15 | 132 | 0.97 | | |
| 100 | | 822.02 | | | | | |
| 101 | 826.67 | 821.55 | 15 | 165 | 0.28 | 169 | -4 |
| 101 | 826.67 | 821.55 | | | | | |
| 102 | 826.46 | 821.43 | 15 | 28 | 0.43 | | |
| 102 | 826.46 | 821.43 | | | | | |
| 103 | 827.3 | 820.97 | 15 | 151 | 0.3 | | |
| 103 | 827.3 | 820.97 | | | | | |
| 104 | 826.67 | 820.48 | 18 | 171 | 0.29 | 174 | -3 |
| 104 | 826.67 | 820.48 | | | | | |
| 105 | 826.78 | 820.28 | 18 | 58 | 0.34 | 57 | 1 |
| 105 | 826.78 | 820.28 | | | | | |
| 106 | 826.7 | 820.09 | 18 | 28 | 0.68 | | |
| 106 | 826.7 | 820.09 | | | | | |
| Existing | 811.47 | 806.97 | 18 | 161 | 3.94 | 162 | -1 |
| 112 | 825.26 | 823.02 | | | | | |

| | | | | | | | |
|-----|--------|--------|----|-----|------|-----|-----|
| 111 | 826.76 | 822.68 | 12 | 126 | 0.27 | 125 | 1 |
| 111 | 826.76 | 822.68 | | | | | |
| 110 | 826.8 | 822.49 | 12 | 43 | 0.44 | 45 | -2 |
| 110 | 826.8 | 822.49 | | | | | |
| 109 | | 821.91 | 15 | 167 | 0.35 | 169 | -2 |
| 121 | 831.76 | 828.98 | | | | | |
| 118 | 831.98 | 827.35 | 12 | 115 | 1.41 | 103 | 12 |
| 118 | 831.98 | 827.35 | | | | | |
| 117 | 831.21 | 827.11 | 12 | 14 | 1.71 | 26 | -12 |
| 117 | 831.21 | 827.11 | | | | | |
| 116 | 831.17 | 826.68 | 15 | 28 | 1.53 | | |
| 116 | 831.17 | 826.68 | | | | | |
| 115 | 828.86 | 824.16 | 15 | 151 | 1.66 | | |
| 115 | 828.86 | 824.16 | | | | | |
| 114 | | 822.06 | 15 | 62 | 3.38 | | |
| 120 | 833.34 | 830.08 | | | | | |
| 119 | 833.27 | 829.71 | 12 | 29 | 1.27 | 28 | 1 |
| 119 | 833.27 | 829.71 | | | | | |
| 118 | 831.98 | 827.35 | 12 | 124 | 1.9 | 125 | -1 |
| 125 | 835.46 | 832.78 | | | | | |
| 124 | 835.53 | 831.89 | 12 | 137 | 0.65 | 136 | 1 |
| 124 | 835.53 | 831.89 | | | | | |
| 123 | 835.54 | 831.64 | 15 | 28 | 0.89 | | |
| 123 | 835.54 | 831.64 | | | | | |
| 122 | | 822.1 | 15 | 172 | 5.55 | 174 | -2 |

6" SSD Streets:

| | |
|------------------|-------------|
| Fairwood Dr | 1152.5 |
| Wading Crane Ave | 350.25 |
| Wild Turkey Run | 380.25 |
| Soaring Eagle Ln | 561 |
| x2 | |
| Total: | <u>4888</u> |

6" SSD Lots:

| | |
|---------------|------------|
| 15-17 | 185 |
| 1-5 | 435 |
| Total: | <u>620</u> |

RCP Pipe Totals:

| | |
|---------------|-------------|
| 12 | 754 |
| 15 | 1084 |
| 18 | 418 |
| Total: | <u>2256</u> |

The length of the drain due to the changes described above is now **7764 feet**.

The non-enforcement was approved by the Board at its meeting on November 24, 2003 and recorded under instrument #200300122518.

The following sureties were guaranteed by Bond Safeguard Insurance Co. and released by the Board on its January 12, 2004 meeting.

Bond-LC No: 5003804
Insured For: Storm Sewers & SSD
Amount: \$142,065.00
Issue Date: May 29, 2003

Bond-LC No: 5003806
Insured For: Erosion Control
Amount: \$32,689.90
Issue Date: May 29, 2003

I recommend the Board approve the drain's construction as complete and acceptable.

Sincerely,

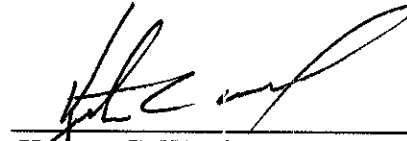
A handwritten signature in black ink, appearing to read 'Kenton C. Ward', written over a horizontal line.

Kenton C. Ward,
Hamilton County Surveyor

KCW/slm

RECORD DRAWING

JEFFERY W. DARLING
 Registered Land Surveyor
 No. 900017

DATE 11/17/03



AS BUILT GRADE ELEV.

"HOLEY MOLEY" SAYS:
 1-800-382-5544
 CALL TOLL FREE
 1-800-428-5200
 FOR CALLS OUTSIDE OF INDIANA

CAUTION
 LOCATION OF ALL EXISTING UNDERGROUND UTILITIES SHOWN ON THIS PLAN ARE BASED UPON ABOVE GROUND EVIDENCE (including, but not limited to, manholes, inlets, valves, & marks made upon the ground by others.) AND ARE SPECULATIVE IN NATURE. THERE MAY ALSO BE OTHER EXISTING UNDERGROUND UTILITIES FOR WHICH THERE IS NO ABOVE GROUND EVIDENCE OR FOR WHICH NO ABOVE GROUND EVIDENCE WAS OBSERVED. THE EXACT LOCATIONS OF SAID EXISTING UNDERGROUND UTILITIES SHOULD BE VERIFIED BY THE CONTRACTOR PRIOR TO ANY AND ALL CONSTRUCTION.

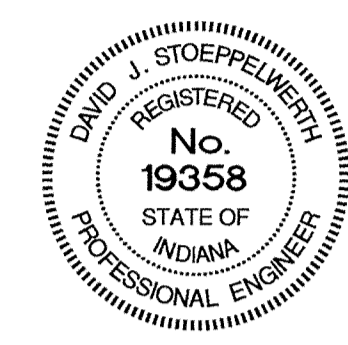

SCALE: 1" = 60'

- LEGEND**
- EXISTING CONTOUR
 - EXISTING SANITARY SEWER
 - EXISTING STORM SEWER
 - PROPOSED GRADE
 - PROPOSED CONTOUR
 - PROPOSED SANITARY SEWER
 - PROPOSED STORM SEWER
 - PROPOSED SWALE
 - PROPOSED 4' SIDEWALK (BY HOME BUILDER)
 - 181 823.3 N.P. SPECIAL DRAINAGE (FROM REAR OF LOT TO FRONT AROUND HOUSE.)
 - L.O. DENOTES NO PAD TO BE BUILT
 - W.O. DENOTES A LOOKOUT BASEMENT
 - PROPOSED 6" UNDERDRAINS
 - 4" S.S.D. LATERALS (NOTE: TO BE USED ON THE WOODED LOTS 6-13, 40-42 AS SHOWN.)
 - 4" S.S.D. LATERALS
 - S.S.D. RISER
 - M.F.F. = MINIMUM FINISH FIRST FLOOR

NOTE: DECORATIVE SIGNS, SPRINKLER SYSTEMS, TREES, LANDSCAPING MOUNDS, LIGHT POLES, OR OTHER SUCH AMENITIES ARE NOT PERMITTED IN THE RIGHT OF WAY.

NOTE: ALL OFF-SITE AND EXISTING DRAIN TILES SHALL BE TIED INTO THE PROPOSED STORM SYSTEM OF THIS SECTION (WHERE APPLICABLE).

NOTE: DEVELOPER HAS THE OPTION NOT TO BUILD BUILDING PADS ON LOTS AS LONG AS POSITIVE DRAINAGE IS ESTABLISHED FROM BUILDING LINE TO STREET AND IN REAR YARD.

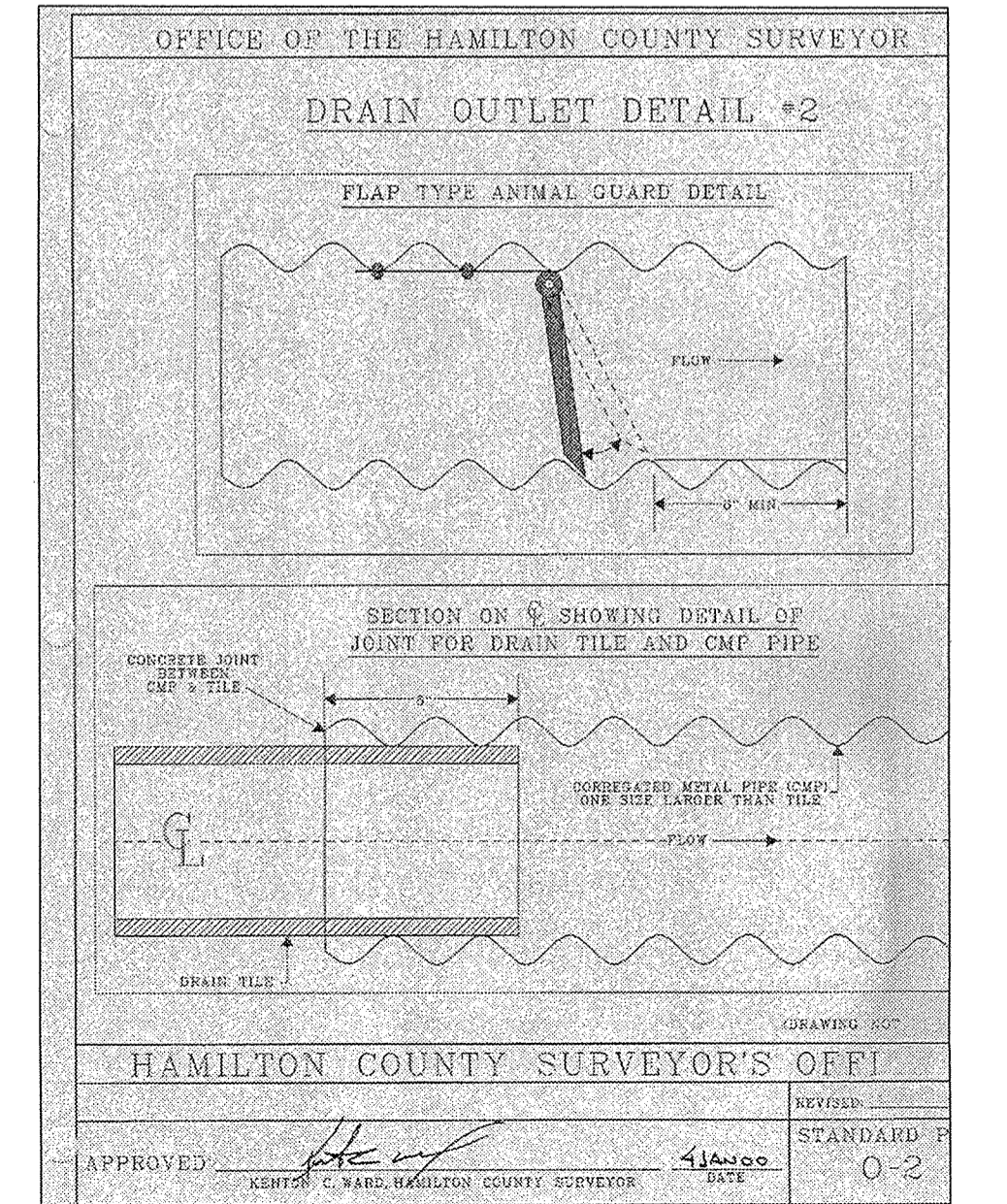

NOTE: LOTS DESIGNATED AS "S.D.L." (SPECIAL DRAINAGE LOTS) DO NOT HAVE A DEFINED REAR SWALE. THE REAR OF LOTS 6-10 MUST SHEET DRAIN TO THE WEST/NORTHWEST AND LOT 11 TO THE EAST/NORTHEAST. ALL FINISH GRADE AND CONSTRUCTION OF NEW HOMES MUST MAINTAIN THE POSITIVE DRAINAGE AND CANNOT IMPEDE THE UPSTREAM FLOW.

NOTE: LOTS 11 THRU 13 HAVE GRADES SHOWN BEHIND PADS FOR POSSIBLE GRADING WHEN HOMES ARE BUILT. THESE GRADES ARE FOR HOME BUILDERS ONLY. THESE ARE NOT FOR CONSTRUCTION OF THE SUBDIVISION.

NOTE TO CONTRACTOR: PRESERVE DRAINAGE TILE ON WEST END OF PROPERTY WHICH SERVICES A DRAINAGE AND GEO THERMAL HEAT SYSTEM (LOTS 40-42, 13). TIE INTO STRUCTURE 108A. FILL REMAINDER OF PIPE WITH GROUT.

NOTE: FAIRWOOD DRIVE SHALL BE SAW CUT TO PROVIDE A SMOOTH TRANSITION OFF-SITE 0.97' A.C.H.

NOTE: S.S.D. OUTLET TO LAKE TO BE INSTALLED BY HOME BUILDER (SEE DETAIL 0-2 ON THIS SHEET)

NOTE: TO CONVERT BENCHMARKS TO NAVD 1983 DATUM, SUBTRACT 0.44 FT. (EXISTING TOP AND PROPOSED GRADES ARE SHOWN PER 1929 DATUM)

BENCHMARKS:
 (NGVD 1929 DATUM)
 A STANDARD INDIANA FLOOD CONTROL AND WATER RESOURCES COMMISSION BRONZE BENCHMARK TABLET (STAMPED "MAR. 91-1956") LOCATED AT GEIST RESERVOIR, 450 FEET SOUTHEAST FROM THE NORTHWEST END OF DAM, 18 FEET SOUTHWEST OF SEARCH LIGHT, 14 FEET ABOVE THE CEMENT SPILLWAY, AND 11.5 FEET NORTHEAST OF STEPS.

(NGVD 1929 DATUM)
 T.B.M. S&A #1
 CUT BOX ON THE EAST END OF THE SOUTHEAST HEADWALL AT THE SOUTHEAST CORNER OF 96TH AND OLIO ROAD.

ELEV. = 798.62

ELEV. = 841.39

| Str. No. | Type | Tc/Rim | Inverts | Direction |
|----------|----------------------|--------|---------|-----------|
| 100 | CONCRETE END SECTION | | 822.00 | (W) |
| 101 | CURB INLET | 826.80 | 821.49 | (W) |
| 102 | CURB INLET | 826.80 | 821.41 | (W) |
| 103 | YARD INLET | 827.20 | 820.46 | (E,N) |
| 104 | YARD INLET | 826.50 | 820.44 | (NW,S) |
| 105 | CURB INLET w/MANHOLE | 826.70 | 822.06 | (NE) |
| 106 | CURB INLET w/MANHOLE | 826.70 | 821.19 | (N,S) |
| 107 | DOUBLE CURB INLET | 827.70 | 822.78 | (NE,SW) |
| 108 | DOUBLE CURB INLET | 827.70 | 823.06 | (NE) |
| 108A | MANHOLE | 833.50 | 823.50 | (E) |
| 109 | CONCRETE END SECTION | | 822.00 | (N) |
| 110 | CURB INLET | 826.70 | 822.51 | (S,NW) |
| 111 | CURB INLET | 826.70 | 822.65 | (SE,N) |
| 112 | YARD INLET | 825.30 | 823.03 | (S) |
| 114 | CONCRETE END SECTION | | 822.00 | (NE) |
| 115 | MANHOLE | 828.00 | 824.00 | (SW,E) |
| 116 | CURB INLET | 831.10 | 826.68 | (E,W) |
| 117 | DOUBLE CURB INLET | 831.10 | 827.10 | (E,W) |
| 118 | MANHOLE | 831.80 | 827.62 | (E,W,N) |
| 119 | CURB INLET | 833.37 | 829.73 | (S,N) |
| 120 | CURB INLET | 833.37 | 829.87 | (S) |
| 121 | YARD INLET | 832.00 | 829.03 | (W) |
| 122 | CONCRETE END SECTION | | 822.00 | (E) |
| 123 | CURB INLET | 835.54 | 831.66 | (E,W) |
| 124 | CURB INLET | 835.54 | 831.80 | (E,W) |
| 125 | YARD INLET | 835.50 | 832.48 | (W) |

LOT 299
 LOT 298
 LOT 297
 LOT 296
 LOT 295
 LOT 294
 LOT 293
 LOT 292
 LOT 80
 LOT 79
 LOT 78
 LOT 77

CERTIFIED: 3/10/03

CONSULTING ENGINEERS - LAND SURVEYORS
 (317) 849-5935 1-800-728-6917 FAX: (317) 849-5942
 INDIANAPOLIS INDIANA

DAVID J. STAPPELER
 REGISTERED PROFESSIONAL ENGINEER
 No. 19358
 STATE OF INDIANA

JEFFERY W. DARLING
 REGISTERED LAND SURVEYOR
 No. 900017
 STATE OF INDIANA

SITE DEVELOPMENT PLAN
 FOX HOLLOW AT GEIST
 SECTION ONE

HAMILTON COUNTY INDIANA

SHEET NO. C200

JOB NO 38010

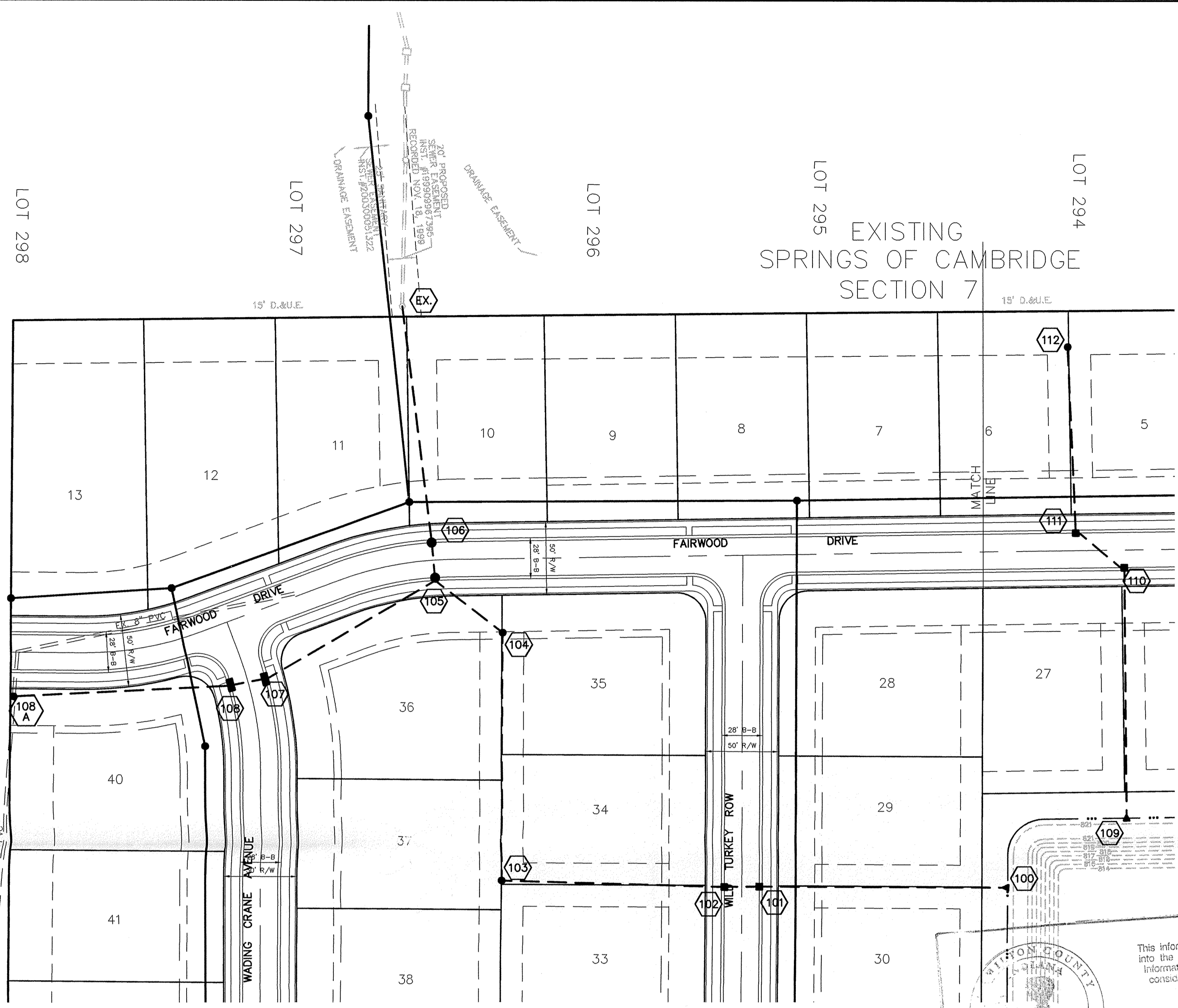

| PIPE SIZE | STRUCTURES LESS THAN 48" FROM T/C TO INVERT | STRUCTURES GREATER THAN 48" FROM T/C TO INVERT | ANGLE AND QUALITY OF PIPES WILL REQUIRE SPECIAL DESIGN | STEPS REQUIRED | CURB CASTING *R-3501 N | CASTING *3501 TL & TR |
|---------------|---|--|--|----------------|------------------------|-----------------------|
| 12" to 18" | 24"x24" | | DESIGN APPROVAL | No | Yes | Yes |
| 12" to 21" | 30"x30" | | DESIGN APPROVAL | No | Yes | Yes |
| 18" to 21" | | MH/BOX | DESIGN APPROVAL | Yes | Yes | Yes |
| 21" to 27" | 24"x36" | | DESIGN APPROVAL | No | No | Yes |
| 12" to 24" | 36"x36" | | DESIGN APPROVAL | No | Yes | Yes |
| 24" OR LARGER | | MH/BOX | DESIGN APPROVAL | No | No | Yes |
| 24" or LARGER | | MH/BOX | DESIGN APPROVAL | Yes** | Yes | Yes |

* PIPES NO LARGER THAN 18" CAN BE USED IN THE 2' SIDE OF THIS BOX
 ** INCOMING AND OUT GOING PIPES EFFECT STEPS IN THIS STRUCTURE

SPECIAL NOTE:
 STRUCTURES DEEPER THAN 48" FROM T/C TO INVERT WILL BE A MH, OR A BOX WITH STEPS UNLESS SPECIAL DESIGN IS APPROVED.

SPECIAL NOTE:
 STRUCTURES WILL BE DESIGNED FOR MAXIMUM FLOW IN PIPES

SPECIAL NOTE:
 COUNTY MAY REQUIRE STEPS TO BE INSTALLED AFTER STRUCTURE IS SET, TO IMPROVE ACCESS.

SCALE: 1"=50'

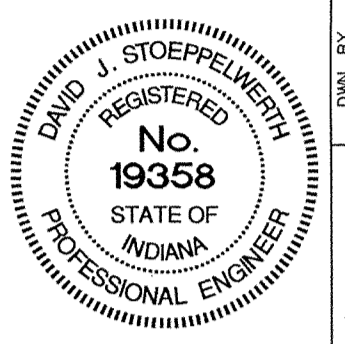

CERTIFIED: 3/10/03
 David J. Stappeler
 CONSULTING ENGINEERS - LAND SURVEYORS
 (317) 849-5935 1-800-728-6917 FAX: (317) 849-5942
 INDIANAPOLIS INDIANA

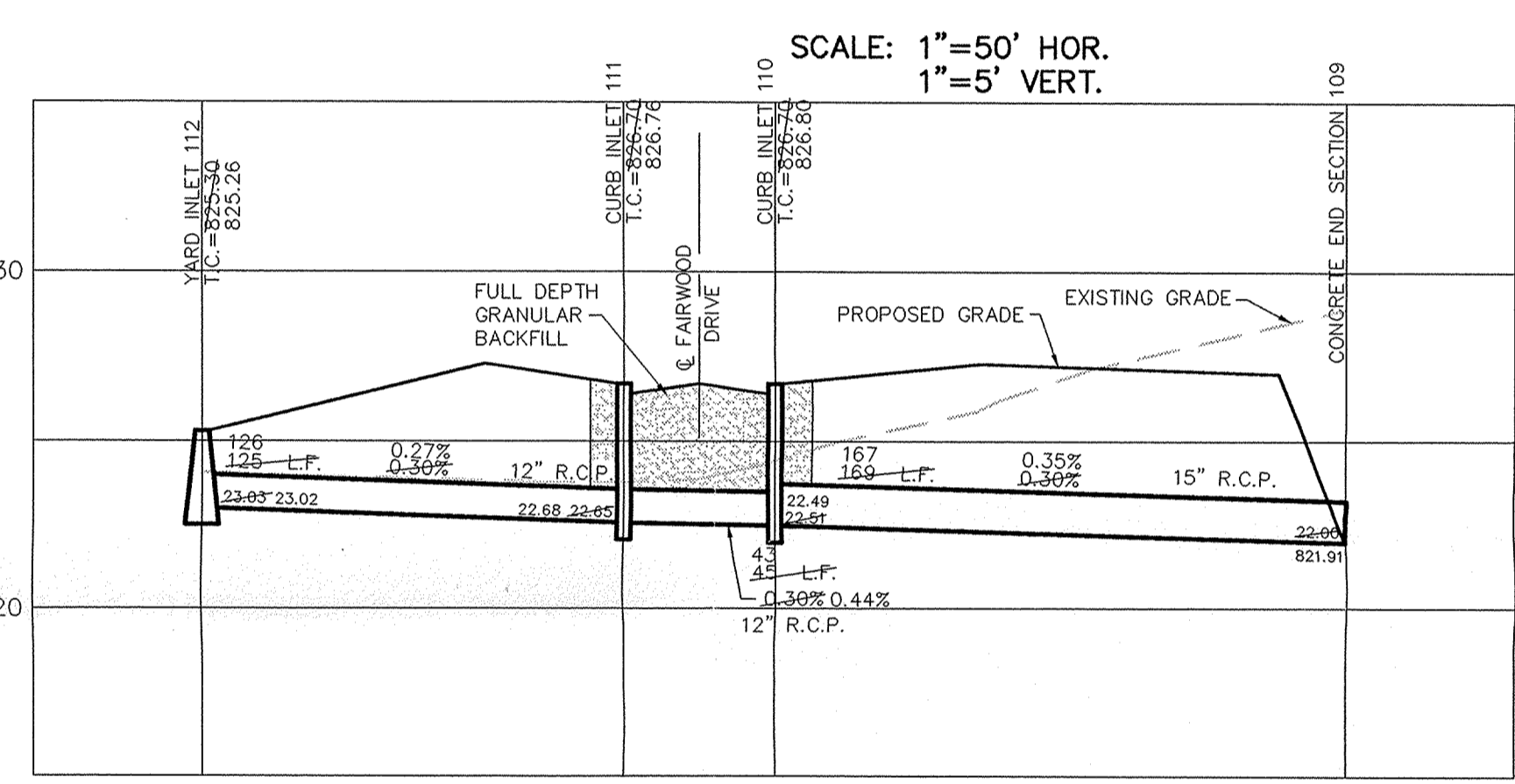

RECORD DRAWING

Jeffery W. Darling
 Registered Land Surveyor
 No. 900017
 DATE 11/14/03

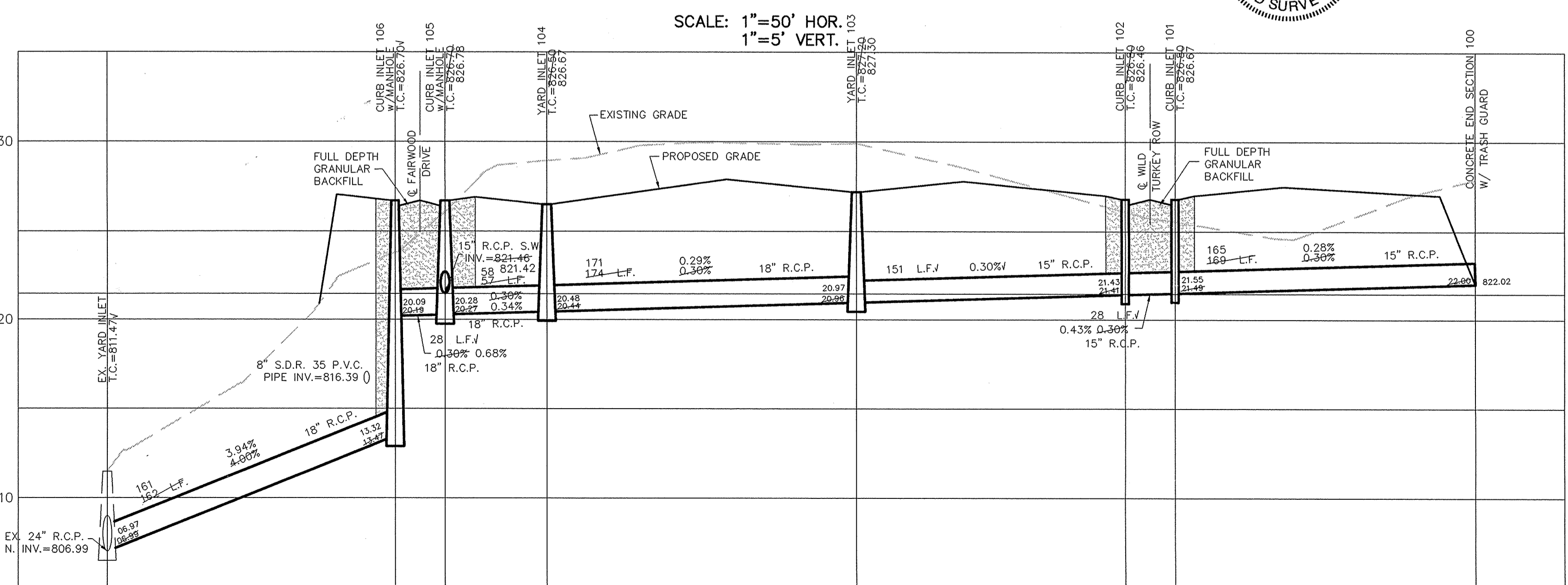
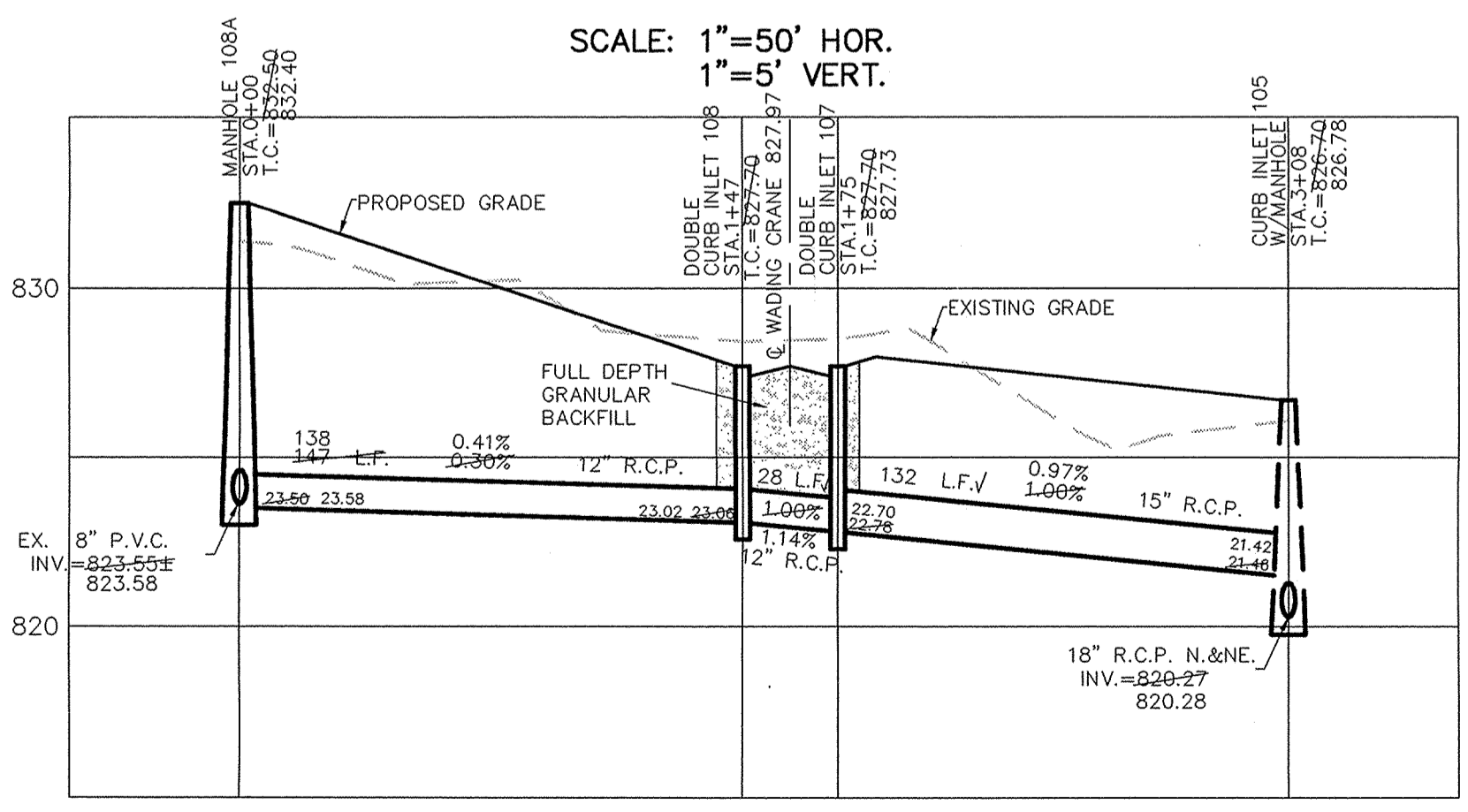

STORM PLAN & PROFILES FOX HOLLOW AT GEIST SECTION ONE

SHEET NO.
C600
 JOB NO. 38010

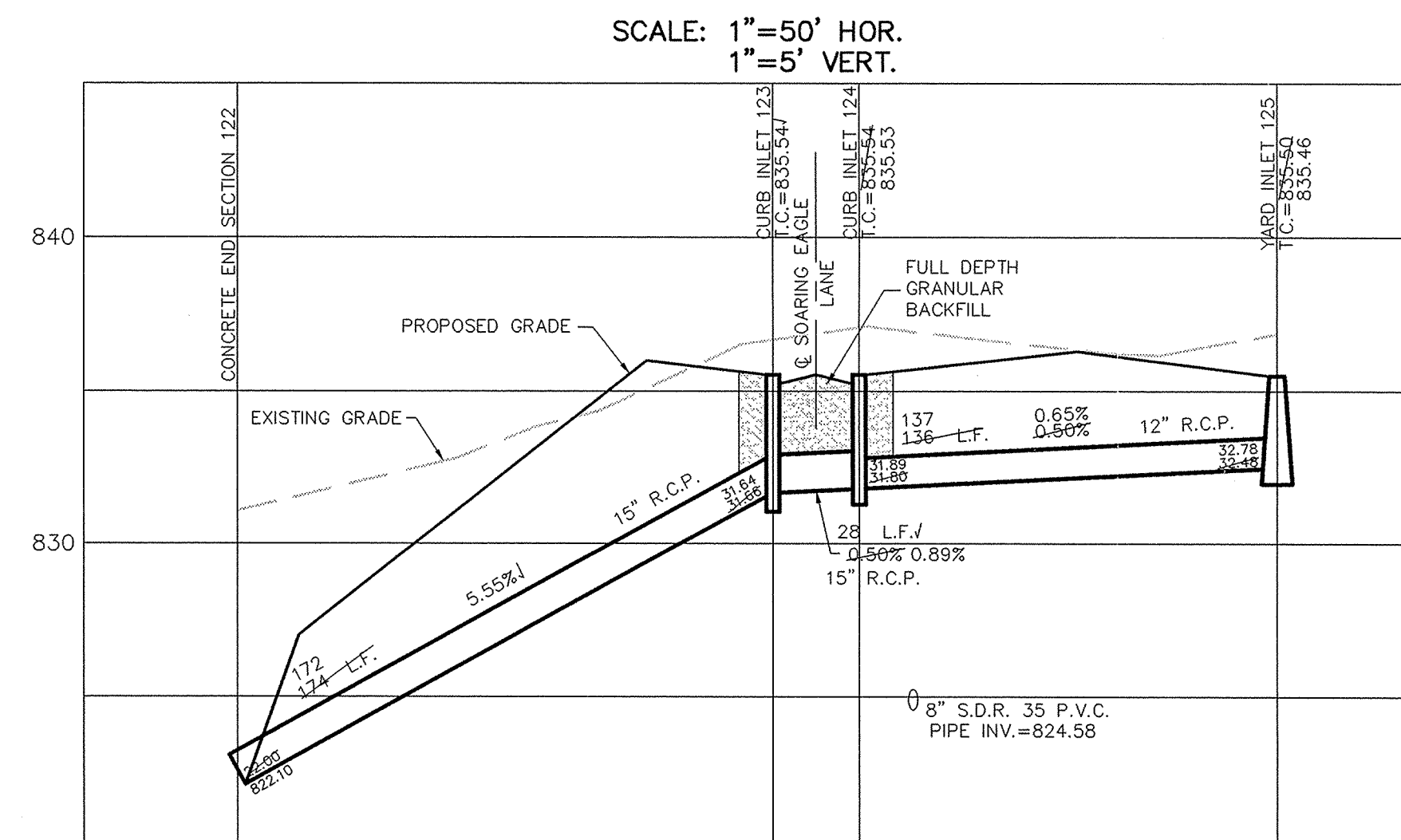
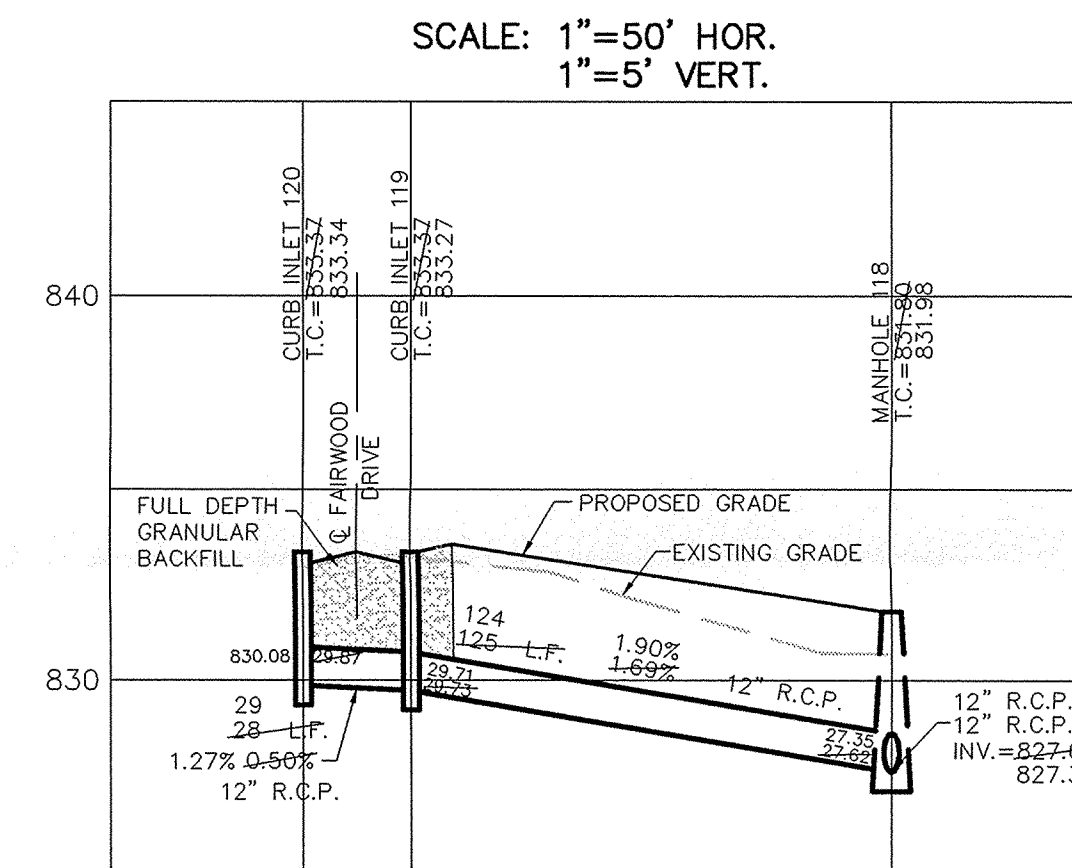
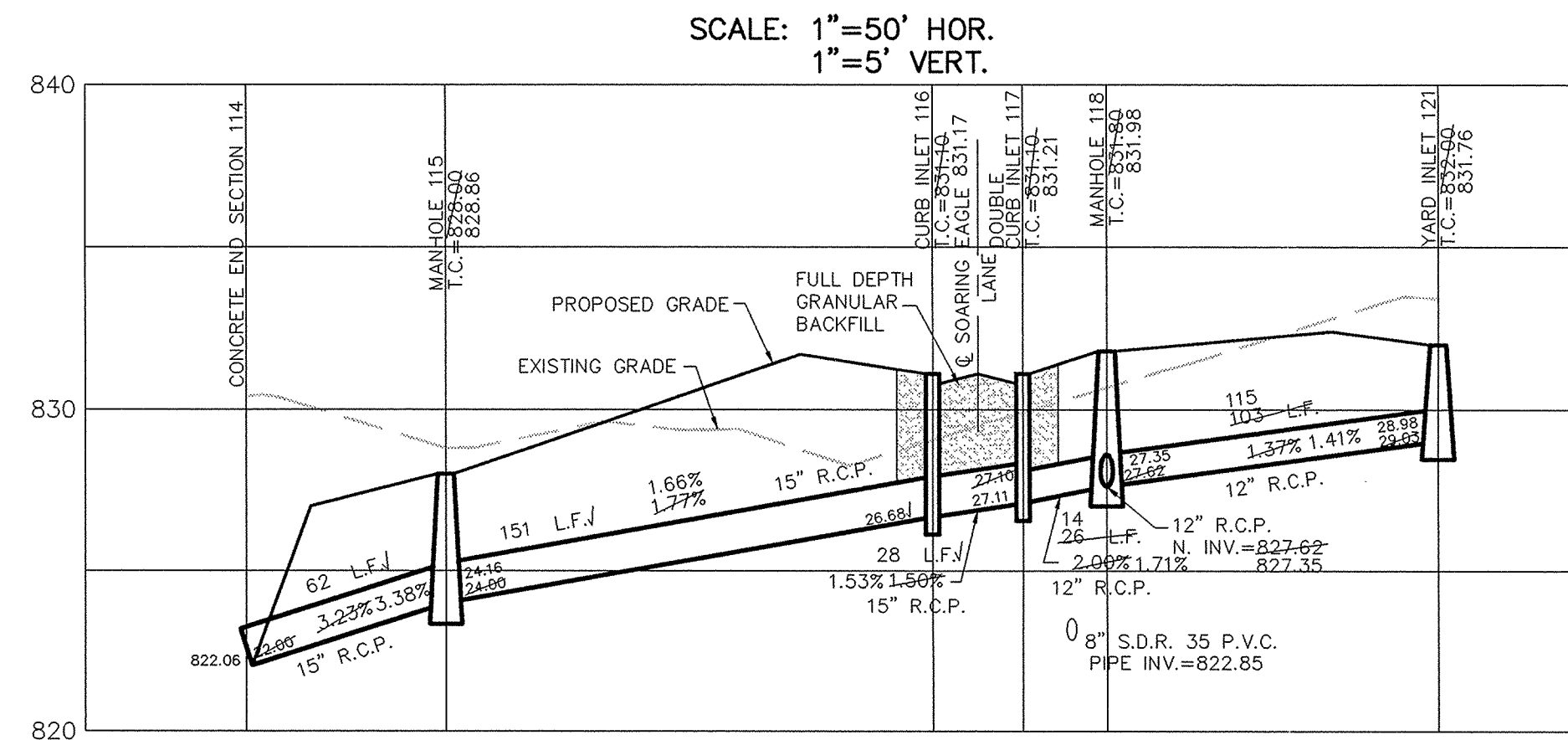
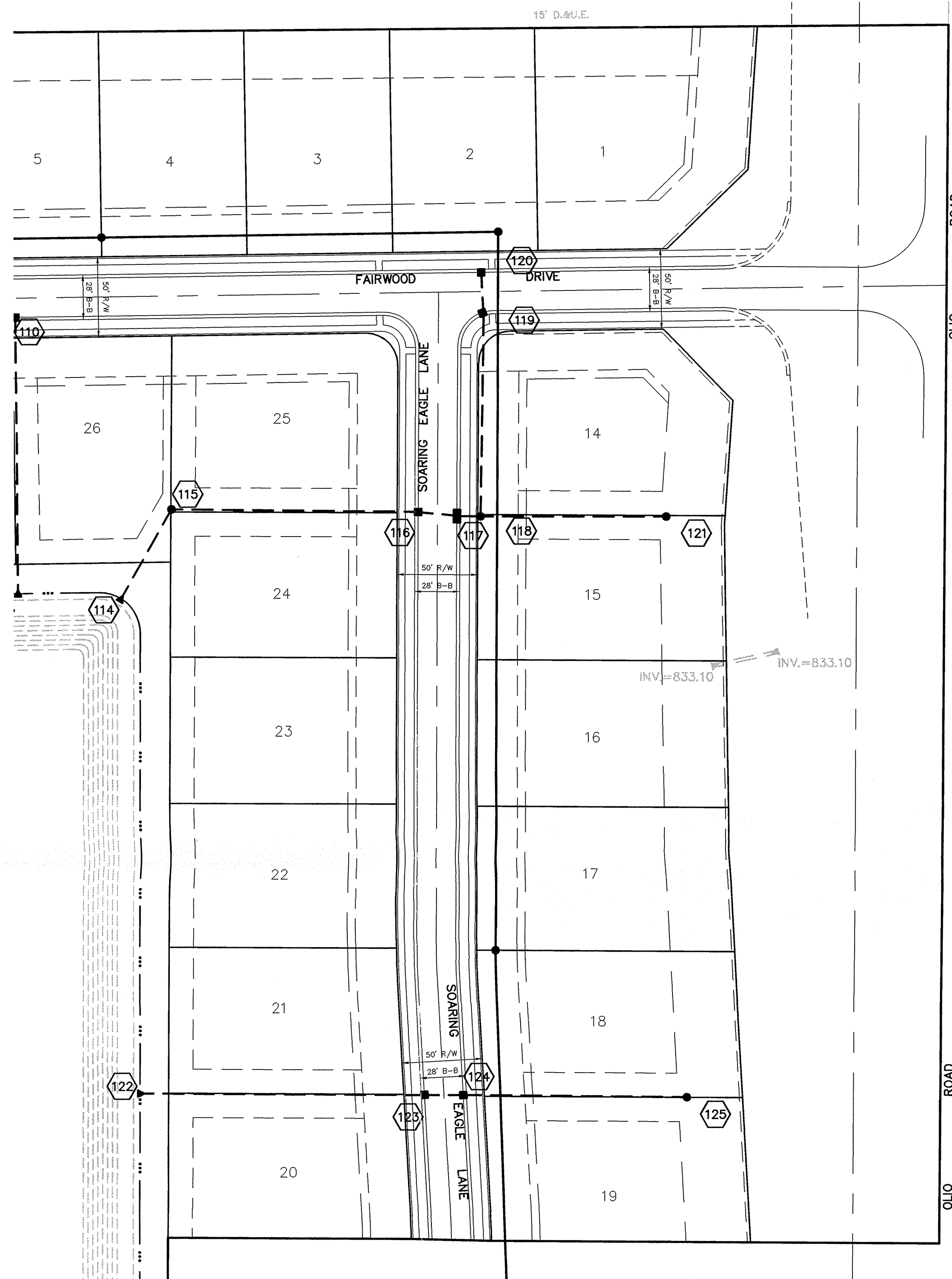

| CURB INLET TABLE | | | | | | |
|------------------|---|--|--|----------------|------------------------|-----------------------|
| PIPE SIZE | STRUCTURES LESS THAN 48" FROM T/C TO INVERT | STRUCTURES GREATER THAN 48" FROM T/C TO INVERT | ANGLE AND QUALITY OF PIPES WILL REQUIRE SPECIAL DESIGN | STEPS REQUIRED | CURB CASTING *R-3501 N | CASTING *3501 TL & TR |
| 12" to 18" | 24"x24" | | DESIGN APPROVAL | No | Yes | Yes |
| 12" to 21" | 30"x30" | | DESIGN APPROVAL | No | Yes | Yes |
| 18" to 21" | | MH/BOX | DESIGN APPROVAL | Yes | Yes | Yes |
| 21" to 27" | 24"x36" | | DESIGN APPROVAL | No | No | Yes |
| 12" to 24" | 36"x36" | | DESIGN APPROVAL | No | Yes | Yes |
| 24" OR LARGER | DESIGN APPROVAL | | DESIGN APPROVAL | No | No | Yes |
| 24" or LARGER | | MH/BOX | DESIGN APPROVAL | Yes** | Yes | Yes |

* PIPES NO LARGER THAN 18" CAN BE USED IN THE 2' SIDE OF THIS BOX
 ** INCOMING AND OUT GOING PIPES EFFECT STEPS IN THIS STRUCTURE

SPECIAL NOTE:
 STRUCTURES DEEPER THAN 48" FROM T/C TO INVERT WILL BE A M.H. OR A BOX WITH STEPS UNLESS SPECIAL DESIGN IS APPROVED.

SPECIAL NOTE:
 STRUCTURES WILL BE DESIGNED FOR MAXIMUM FLOW IN PIPES

SPECIAL NOTE:
 COUNTY MAY REQUIRE STEPS TO BE INSTALLED AFTER STRUCTURE IS SET TO IMPROVE ACCESS.

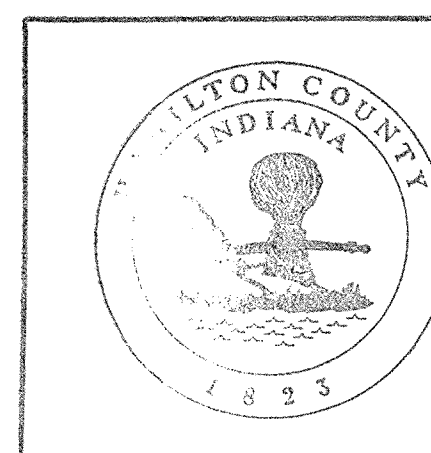

This information was gathered for input into the Hamilton County Geographical Information System. This document is considered an official record of the GIS.

Entry Date: 7-2-04
 Entered by: JPH

RECORD DRAWING

Jeffery W. Darling
 JEFFERY W. DARLING
 Registered Land Surveyor
 No. 900017

DATE: 11/17/03

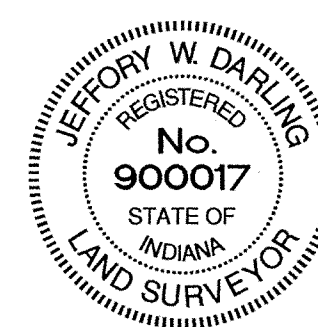

SCALE: 1" = 50'

DATE: 3/10/03

BY: JPH

CERTIFIED: 3/10/03

CONSULTING ENGINEERS - LAND SURVEYORS
 (317) 849-5935 1-800-728-6917 FAX: (317) 849-5942
 INDIANAPOLIS INDIANA

STORM PLAN & PROFILES
 FOX HOLLOW AT GEIST
 SECTION ONE

HAMILTON COUNTY INDIANA

SHEET NO.
C601

JOB NO: 38010

| NO. | DATE | REVISIONS |
|-----|----------|-----------|
| 1 | 11/17/03 | AS BUILT |
| 2 | 3/10/03 | MARK |